



1181 Garden Street Greensburg, PA 15601
Toll Free: 888-891-4416 Phone: 724-832-1903 Fax: 724-837-3759
Email: inforequest@tigerdoor.com Web: www.tigerdoor.com

INSTALLATION INSTRUCTIONS FOR FRP 45 MINUTE TO 90 MINUTE FIRE RATED FRAMES

-BOLTED INTO EXISTING MASONRY OPENING-

ASSEMBLE FRAME using stainless steel screws provided. Match up frame "Mk." numbers. Make sure the header is oriented so that door closer reinforcement is located towards the *hinge* jamb. Prior to installation, check all parts for size and correctness before proceeding. *Check to insure that correct opening width exists between jamb uprights and that corner connections are not twisted.*

CHECK FRAME BEFORE INSTALLATION– Prior to installation, and removal of any existing unit, check all parts for size and correctness before proceeding! Check for correct opening width and height inside frame and that corner connections are not twisted. NOTIFY YOUR DISTRIBUTOR, TIGER SALES REPRESENTATIVE, OR THE FACTORY IMMEDIATELY OF ANY DISCREPANCIES.

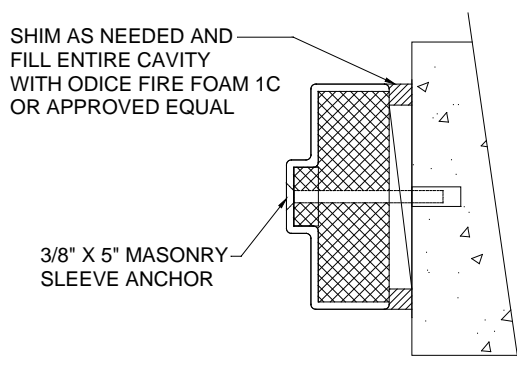

SET FRAME in the opening, using shims as necessary to take up excess clearance, and under jamb uprights to level header. *It is critical at this point to make sure that frame is set plumb and square.* Drill anchor holes in wall. Note that frames wider than 52 inches require a center bolted

anchor in the header as well. Use shims as necessary to adjust for plumb on hinge jamb and tighten the hinge jamb anchors only. *Recheck to make sure that hinge jamb is perfectly plumb.*

HANG DOOR – If **mortised hinges** are used, screw holes are factory predrilled on frames using standard Tiger Door hinge locations. *Use only Tiger Door supplied screws to hang the door on the frame – do not use the screws furnished with the hinges.*

If **continuous hinges** are used, field drilling of pilot holes will be required. Tiger Door recommends that a minimum of a #12 x 1" sheet metal screw in combination with a 5/32" pilot hole be used for hinge attachment. Shorter or smaller screws may not provide sufficient pullout resistance.

Check for proper operation by gently closing door against the latch side jamb. Install and adjust shims behind latch jamb as necessary to maintain a uniform 1/8" (±) clearance between the door edge and frame. Now check that door face uniformly contacts latch side door stop at both top and bottom corners. Adjust jamb if necessary by pushing the bottom (or top) of the jamb toward the inside (or outside) face until door stop is parallel with the face of door. (Note: This may cause the latch jamb to be negligibly out of plumb, but is necessary in some cases to insure proper door operation and sealing.) Finally, tighten the remaining anchor bolts to secure the frame

FASTENERS – Sheet metal screws with full length threads and pilot holes are required for fastening door hardware to frames. Self-tapping or combination wood/metal screws shall not be used. Failure to follow these fastener requirements may void the Tiger Door product warranty.



#12 x 1-1/4" SS SHEET METAL SCREW INTO JAMB
(FURNISHED BY TD)



#12 x 3" SS SHEET METAL SCREW INTO DOOR
(FURNISHED BY TD WITH DOOR)

BUTT HINGE FASTENERS FOR FRP FRAME AND DOOR

INSTALL BALANCE OF DOOR HARDWARE and check again for proper operation. Adjust hardware as necessary to fine tune door operation. Finally, install weather stripping, sweep, and/or threshold, if applicable. Recheck installation after 1 week.